

MCU-L2/ONE

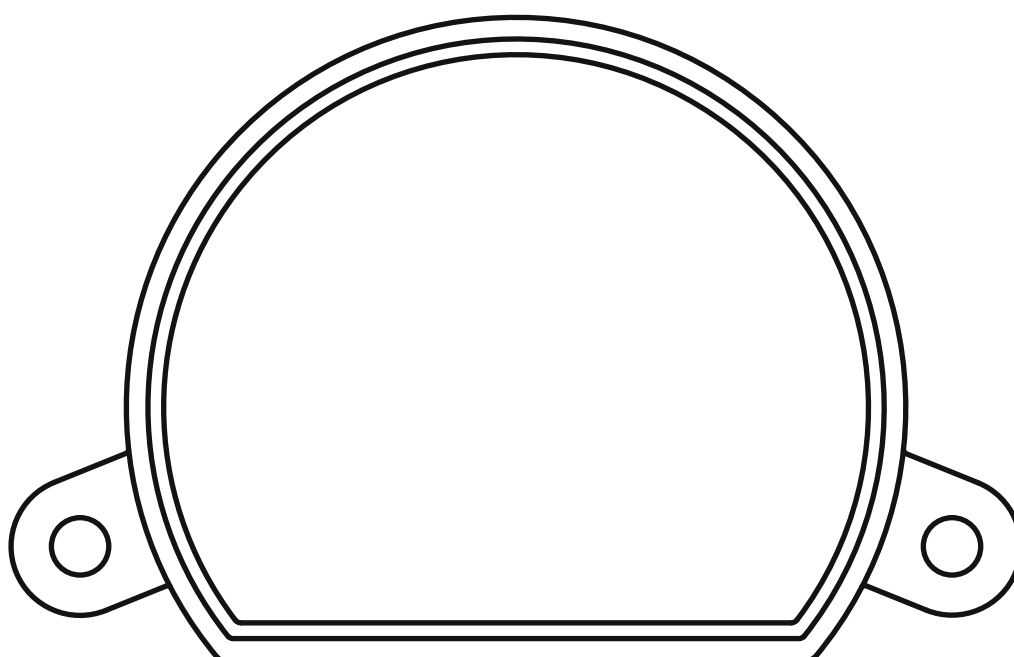

**Control unit for 230Vac loads.
Power supply 230Vac, 2 outputs Max 200W each.
Integrated 433.92 MHz radio receiver.
WiFi connection for OneSmart App.**

INDEX

1 - PRODUCT FEATURES	
1.1 - TECHNICAL DATA	page 3
<hr/>	
2 - CONNECTION DIAGRAMS	
2.1 - CONNECTION DIAGRAM WITH NEUTRAL FROM CONTROL UNIT	page 4
2.2 - CONNECTION DIAGRAM WITH NEUTRAL FROM THE ELECTRICAL SYSTEM	page 5
<hr/>	
3 - USE OF THE CONTROL UNIT	
3.1 - TYPICAL INSTALLATION	page 6
3.2 - USE VIA WIRE	page 7
3.3 - USE VIA RADIO	page 7
3.4 - USE WITH SMART PHONE APPLICATION	page 7
3.5 - USE WITH VOICE CONTROL	page 7
<hr/>	
4 - CONTROL BY RADIO TRANSMITTERS	
4.1 - PROGRAMMING OF THE REMOTE CONTROLS ASSOCIATED WITH OUT 1	page 8
4.2 - PROGRAMMING OF THE REMOTE CONTROLS ASSOCIATED WITH OUT 2	page 9
4.2 - DELETION OF RADIO TRANSMITTERS	page 9
<hr/>	
5 - CONTROL WITH APP ONE SMART	
5.1 - APP ONE SMART CONNECTION	page 10
5.2 - USE OF THE APP ONE SMART	page 11
<hr/>	
6 - CONTROL BY VOICE COMMANDS	
6.1 - CONNECTION TO THE APP "GOOGLE HOME"	pagina 12
6.2 - CONNECTION TO THE APP "AMAZON ALEXA"	pagina 14
<hr/>	
7 - ADVANCED PROGRAMS	
7.1 - ADVANCED PROGRAM	pagina 16
7.2 - FUNCTION CUSTOMIZATION OF THE "WIRELESS BUS" TRANSMITTER BUTTONS	pagina 17
7.3 - SETTING TIMING	pagina 18
7.4 - RESET	pagina 19
<hr/>	

1 - PRODUCT FEATURES

1.1 TECHNICAL DATA

Power supply (Input)	230Vac
Load type (Output)	2 X 230Vac load
Max power load (Output)	Max 200W for output
N° of programmable transmitters	30 in total
RF receiver frequency	433.920MHz
WiFi frequency	2.4GHz
Protection rating	IP20
Working temperature	-20° +55°
Box dimensions	52x43x21 mm

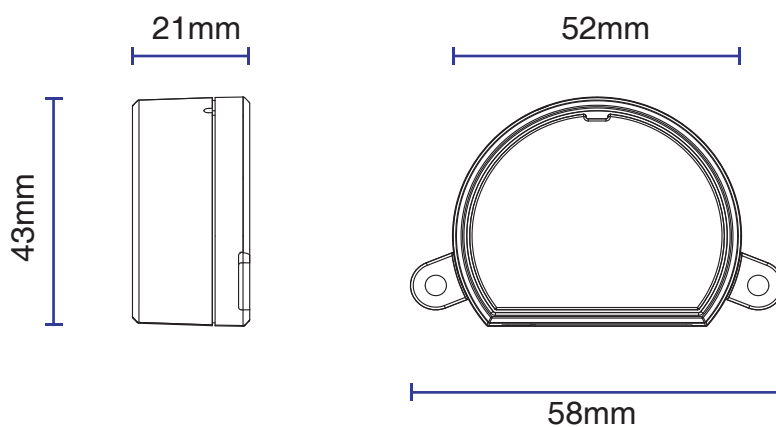
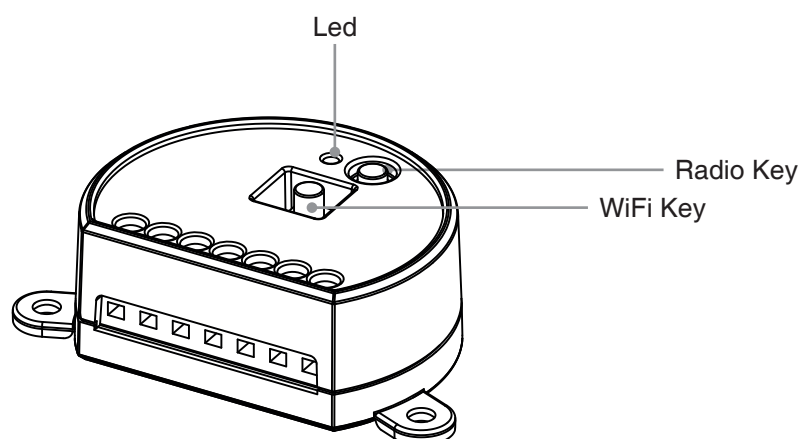

2 - CONNECTION DIAGRAMS

RECOMMENDATIONS

- Installation must be carried out only by professional technicians in accordance with the applicable electrical and safety regulations.
- All connections shall be operated without electrical voltage.
- Use proper cables.
- Don't cut the antenna
- Provide in the power line with an appropriate disconnection device
- Dispose of waste materials in full compliance with local law.
- Do not exceed the specified load limits and use correctly protected power supplies.

2.1 CONNECTION DIAGRAM WITH NEUTRAL FROM CONTROL UNIT

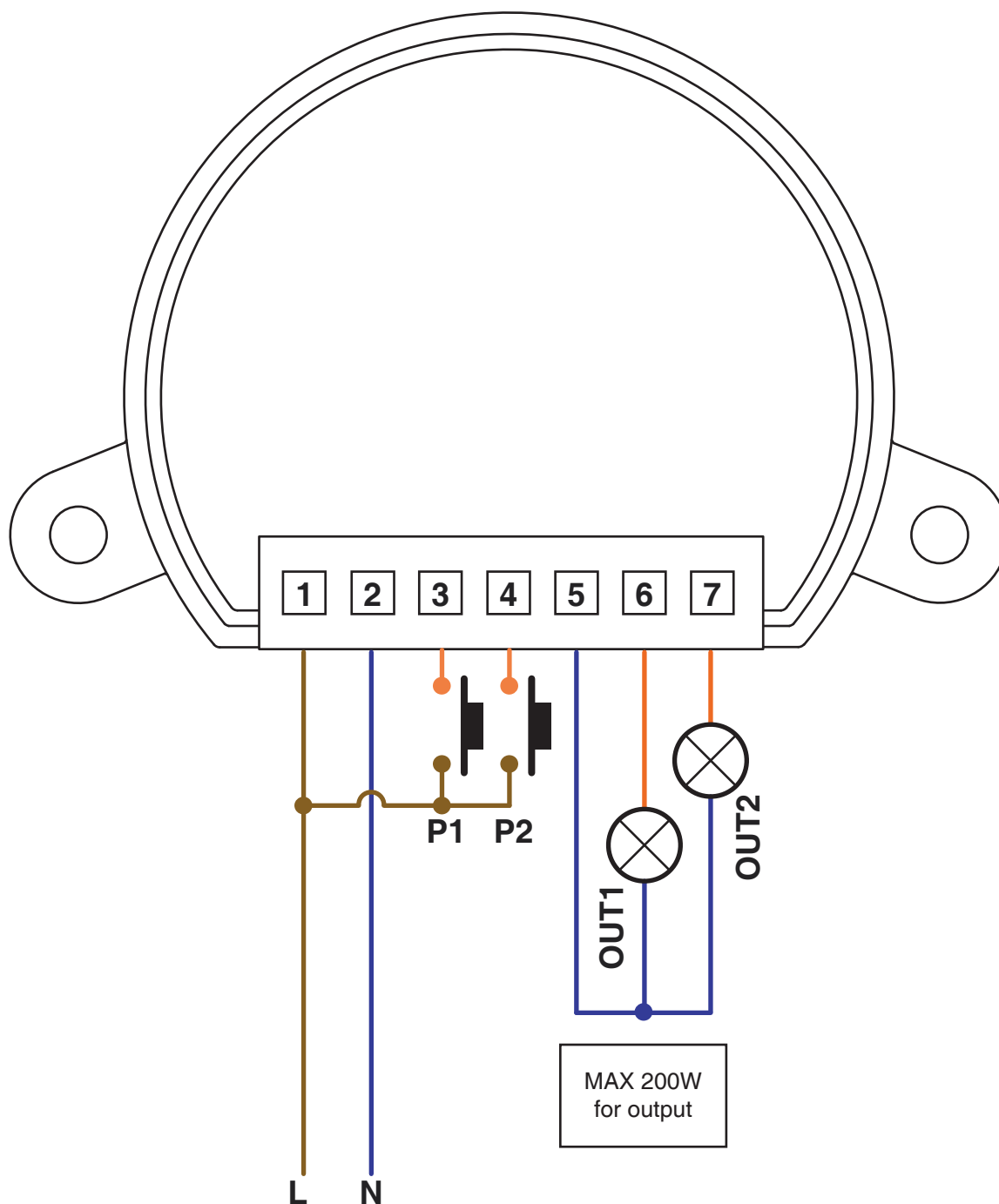

The wired input can be set as a switch, see paragraph 7.1

2.2 CONNECTION DIAGRAM WITH NEUTRAL FROM THE ELECTRICAL SYSTEM

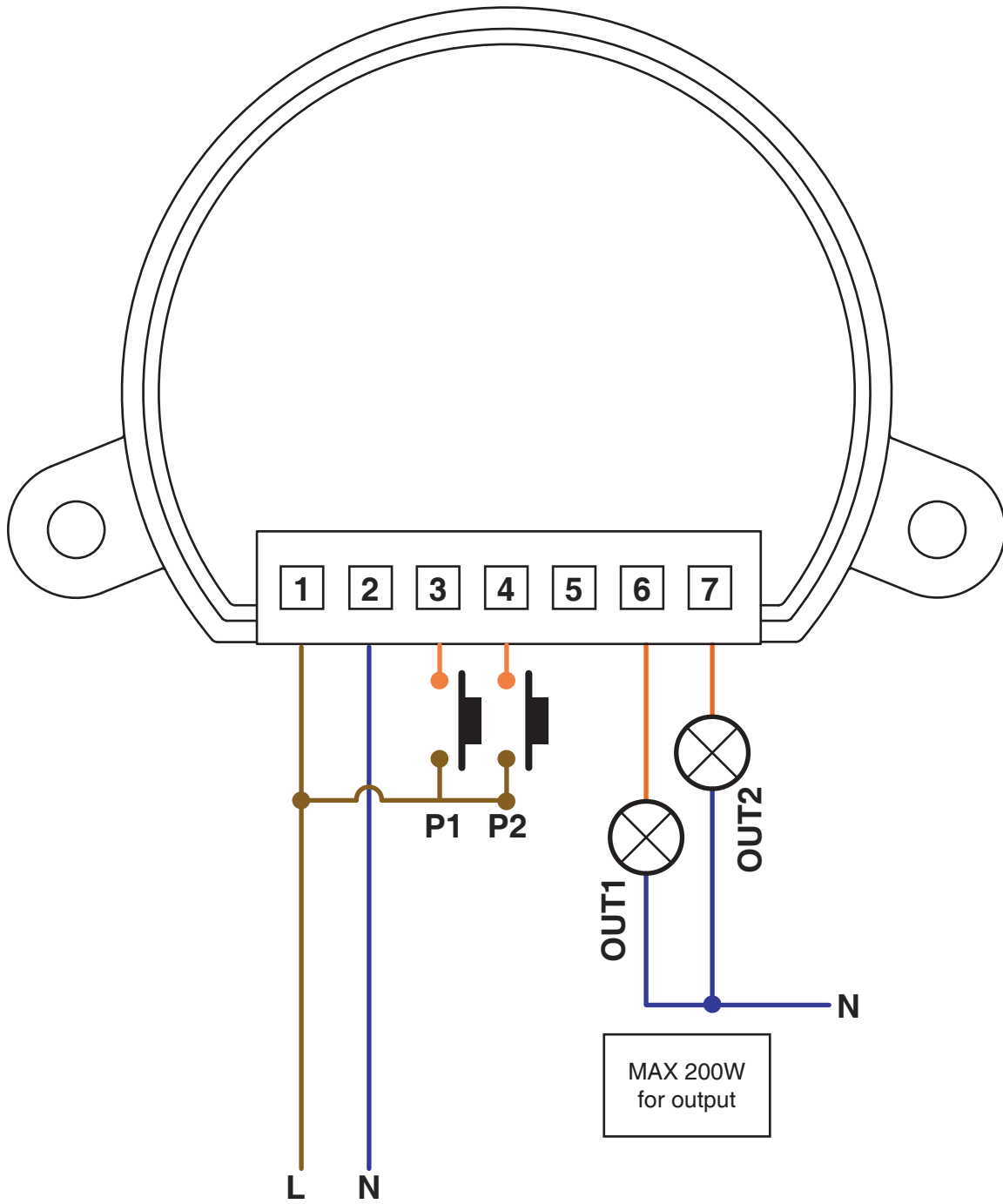

The wired input can be set as a switch, see paragraph 7.1

3 - USE OF THE CONTROL UNIT

3.1 TYPICAL INSTALLATION

The system can be controlled by a wired push button, radio commands, smart phone app, OneSmart or voice commands. The installation can operate with only radio controls or application only. Instead, to use voice commands, at least the app. configuration must be completed.

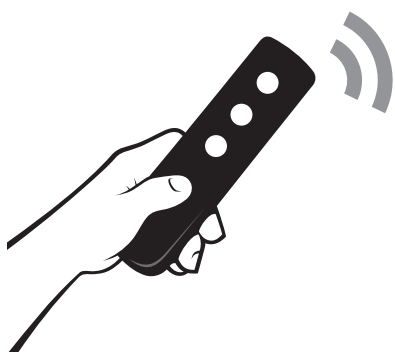

RADIOTRANSMITTER CONFIGURATION

See paragraph 4

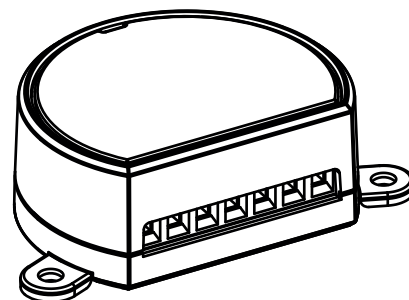

NEXTA CONTROL UNIT

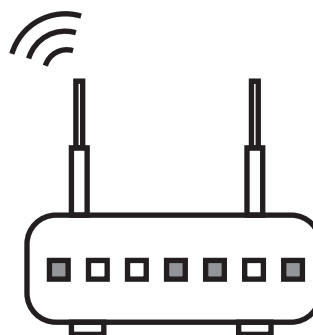

ROUTER WITH INTERNET
CONNECTION



APP CONTROL CONFIGURATION

See paragraph 5



VOICE CONTROL CONFIGURATION

See paragraph 6

3.2 USE VIA WIRE

Once connected, the buttons is already active with On/Off function.

3.3 USE VIA RADIO

To control the loads via radio you must have compatible transmitters and therefore must carry out the association procedure, see paragraph 4.

3.4 USE VIA SMART PHONE APP ONESMART

The configuration procedures described in paragraph 5 above must be followed to control the lights by smart phone App.

3.5 USE WITH VOICE CONTROL

The configuration procedures described in paragraph 6 above must be followed to control the lights by voice commands.

4 - MANAGEMENT WITH REMOTE CONTROL

This procedure lets you programme/delete compatible transmitters.

Multifunctional transmitters, codes:

HB70-SLCT, HB70-SPCT,
HB80-1C, HB80-1DIM, HB80-2L, HB80-30D, HB80-30RGBW, HB80-4C, HB80-4DIM, HB80-4L,
HB90-6LT,
ROUND-1SP,
SENSA-M, SENSA-P, SENSA-R35M, SENSA-R35P, SENSA-R35T, SENSA-T,
TOUCH-1, TOUCH-1CCT, TOUCH-1DIM, TOUCH-1SP, TOUCH-1L, TOUCH-1RGBW, TOUCH-3C, TOUCH-4DIM, TOUCH-CFU

With multifunctional transmitters the transmitter control modes depend on the model used.

Refer to the transmitter manual, to the paragraph entitled “commands sent by the transmitter”, bearing in mind that this is an On/Off device.

Generic (wireless bus) transmitters, codes:

HB80-6G, MCU-TX4, TOUCH-1G, TOUCH-2G, TOUCH-4G, TOUCH-LOCK4, TOUCH-TX2, ROUND-1G

With generic transmitters, the function of the button is On/Off

The function of the generic transmitters can be customized using the procedure in paragraph 7.2.

4.1 - RADIO PROGRAMMING ASSOCIATED WITH OUTPUT 1

This procedure lets you programme compatible multifunctional or generic transmitters.

STEP 1

Press the button radio on the receiver for a short time.
The LED comes on and stays on.

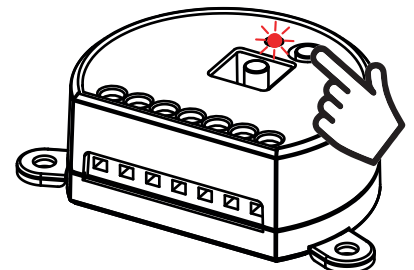

AZIONE: Short pressure RADIO button **LED:** Turns on red

STEP 2

Within 60 seconds make a transmission with the transmitter to be saved.

The LED on the receiver Flashes 3 times and turns off.

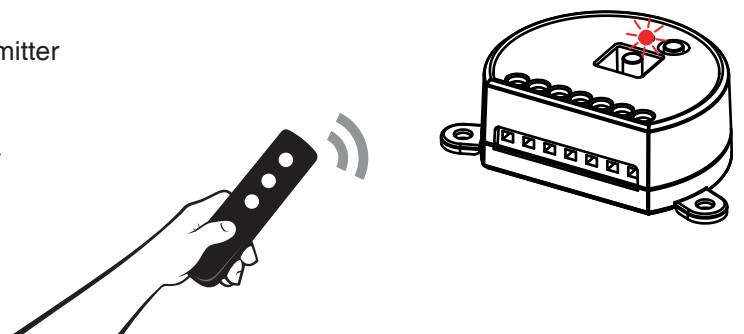

AZIONE: Short pressure **LED:** Flashes 3 times

4.1 - RADIO PROGRAMMING ASSOCIATED WITH OUTPUT 2

This procedure lets you programme compatible multifunctional or generic transmitters.

STEP 1

Press the button WIFI on the receiver for a short time.
The LED comes on and stays on.

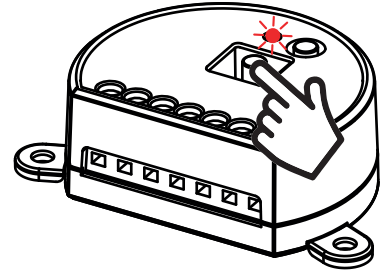

AZIONE: Short pressure WIFI button **LED:** Turns on red

STEP 2

Within 60 seconds make a transmission with the transmitter to be saved.

The LED on the receiver Flashes 3 times and turns off.

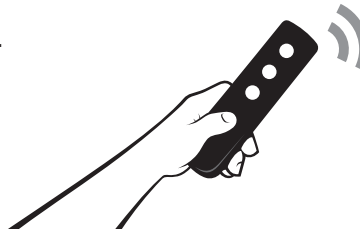

AZIONE: Short pressure **LED:** Flashes 3 times

4.2 - DELETION OF REMOTE CONTROL

These procedures let you delete from the memory transmitters that have already been programmed.

STEP 1

Hold the receiver button RADIO down (about 8 seconds.)
until the LED begins to Flash.

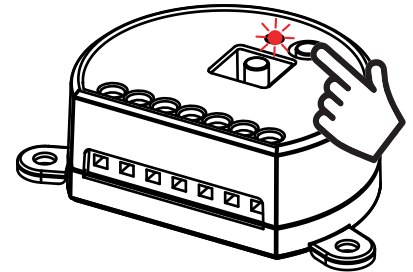

ACTION: Hold button RADIO down **LED:** Flashes red

**DELETION OF SINGLE
TRANSMITTER**

**DELETION OF ALL
TRANSMITTER SAVED**

STEP 2a

Within 10 seconds make a transmission with the transmitter that you want to delete.
The LED flashes quickly and turns off.

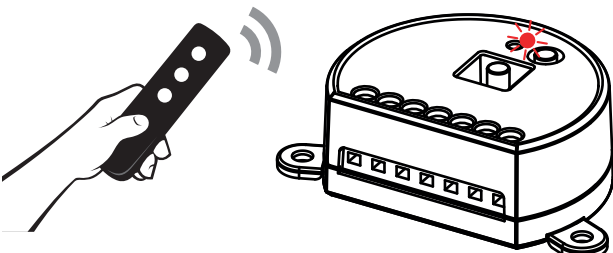

ACTION: Make a transmission with the transmitter
LED: Flashing quickly and turns off

STEP 2B

Within 10 seconds press the button RADIO on the receiver for a short time to confirm the deletion of all transmitters.
The LED starts Flashing quickly and turns off.

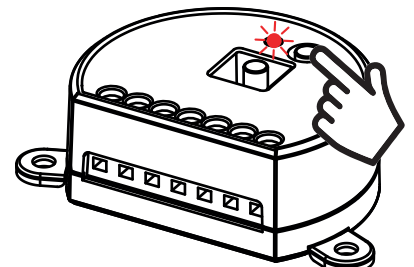

ACTION: Short press of button RADIO
LED: Flashing quickly and turns off

5 - CONTROL WITH APP ONE SMART

These procedures allow you to manage the light from your device (example: mobile phone) through the application and to control the system remotely.

5.1 - APP CONNECTION

This procedure connects the control unit to the application. It shall be repeated for each control unit on the installation.
ATTENTION: an internet-based Wi-Fi network is required for the operation.

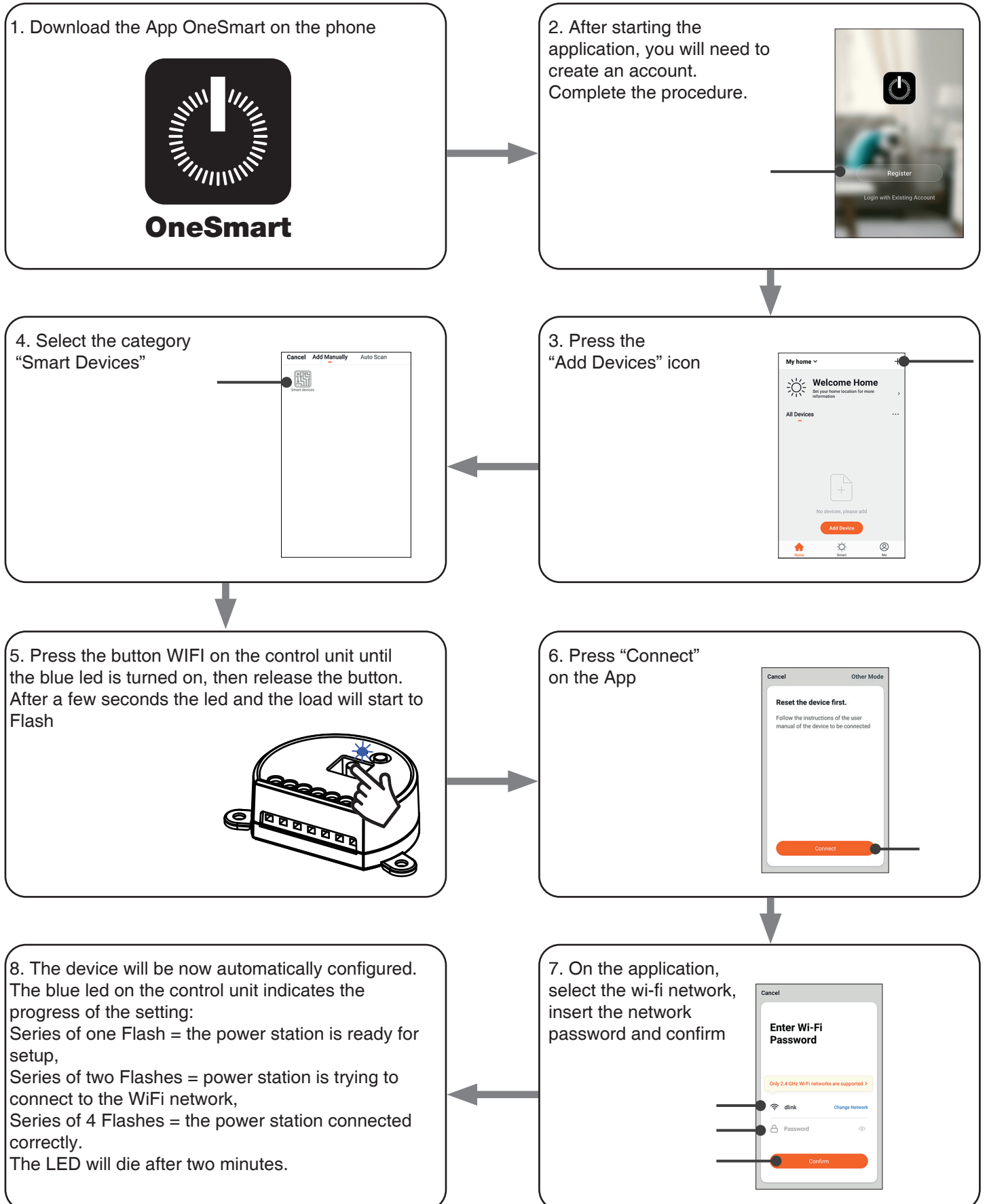

5.2 - USE OF THE APP ONE SMART

After all the control units have been set up, the installation can be managed by the application.

USE

The “Home” menu (1) shows all the associated devices.
To send a command to a device, select it.

Pressing “Smart” (2) allows you to add actions on your devices according to certain conditions and in certain time intervals, there are two types of actions:

- Automation (3): One or more actions happen if one or more conditions are satisfied
- Tap-to-Run (Scenario) (4): performs one or more actions by pressing an app button

EXAMPLES OF SCENARIOS (TAP-TO-RUN):

- Total off (switch off all the lights in the house)
- Scenario Soft (Dimming the desired lights at low intensity level)

EXAMPLES OF AUTOMATIONS:

- Hourly and weekly programmms
- Turn on the lights at the sunshine, turn off the lights at the sunrise.

Pressing “Me” (5) for entering to home and account settings.

From this menu, you can add members to the home for sharing device management or creating new houses.

PROCEDURE PFOR ADDING NEW USERS/MEMBERS.

1- From the “ME” menu (5), select “Home Management” (7) and then go to the house configurations and find “Add Member”

2- Insert the “OneSmart” account you want to add (email or mobile phone number of the new member), the new member will receive a notification of the invitation.

WARNING:

- The new user must have already downloaded the “OneSmart” application and created an account.
- Both the ‘administrator’ and the ‘new user’ must have set the same ‘region’ (Country).
- (Go to “Account (2)-Account and Security-Region” to view and change the set country).

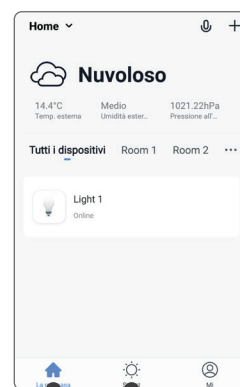

Home (1) Smart (2)

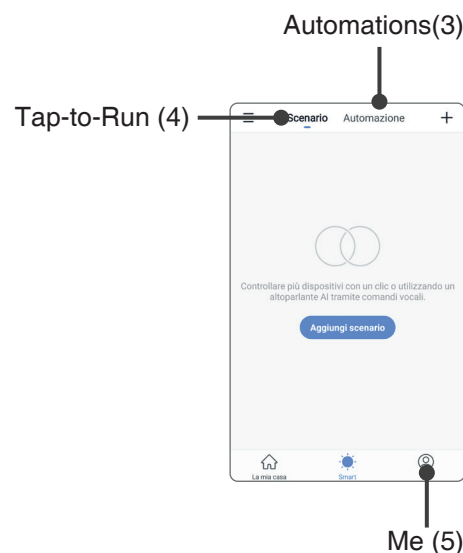

Automations(3)

Tap-to-Run (4)

Me (5)

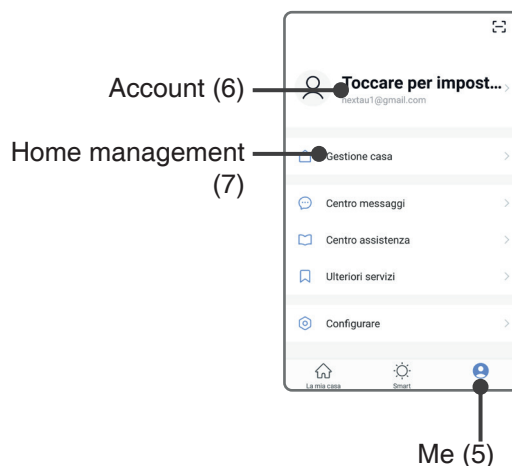

Account (6)

Home management (7)

Me (5)

6 - CONTROL BY VOICE COMMANDS

You can use this procedure to associate a “OneSmart” account with a Google or Alexa account to enable the voice commands.

6.1 - CONNECTION TO “GOOGLE HOME”

PROCEDURE

WARNING: before proceeding with this procedure, you must have set up the “OneSmart” account, see paragraph 5.

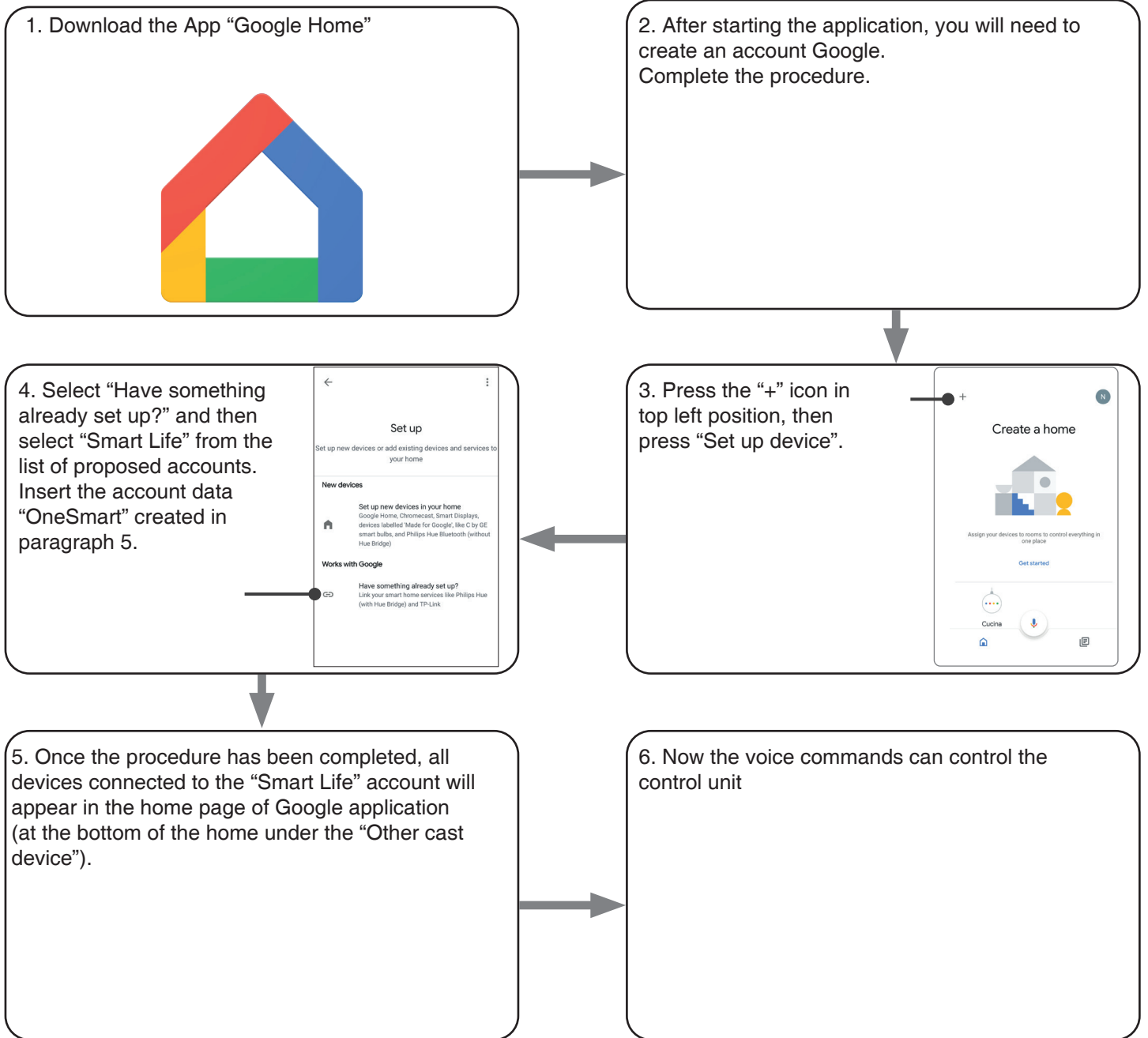

NOTES:

If you add other devices to your OneSmart application, they will automatically be added to the Google Home page. To use them with voice control, you need to add them to a room in the Google Home application, see step 6 of the procedure.

If devices are not added automatically, disconnect and reconnect your account from step 3 of this procedure from Google Home.

USE OF “GOOGLE HOME”

SENDING VOICE COMMANDS

Using your Android mobile phone (or tablet), voice commands can already be sent via the native assistant. By using an Apple device, you can use the microphone within the Google Home application. If you want to add a voice recognition device such as “Google Home Mini” or “Google Home”, follow the procedures to match it to the house you created and then they will be associated with the lights.

VOICE COMMAND LIST

Here below there are some examples of dedicated voice commands for lights:

OK Google, Turn on / Turn Off *name of the device* or *name of the room*

OK Google, Turn on / Turn Off the lights

OK Google, turn off all the lights

USE OF ROUTINES

The Nexta control unit is compatible with Google routine.

The Google Home application allows you to create some vocal commands to be associated with one action or sequence of actions.

This allows you to create scenarios, but also allows you to customize the command to get a certain action.

EXAMPLES OF SCENARIOS

OK Google, Dark! Turn off all the lights

OK Google, Movie! Turn off some lights and soft dimming of other lights

EXAMPLES OF CUSTOMIZED COMMANDS

OK Google, Dark! Turn off the light

(corresponds to the native “Turn off *light name*” command)

6.2 - CONNECTION TO “AMAZON ALEXA”

PROCEDURE

WARNING: before proceeding with this procedure, you must have set up the “OneSmart” account, see paragraph 5.

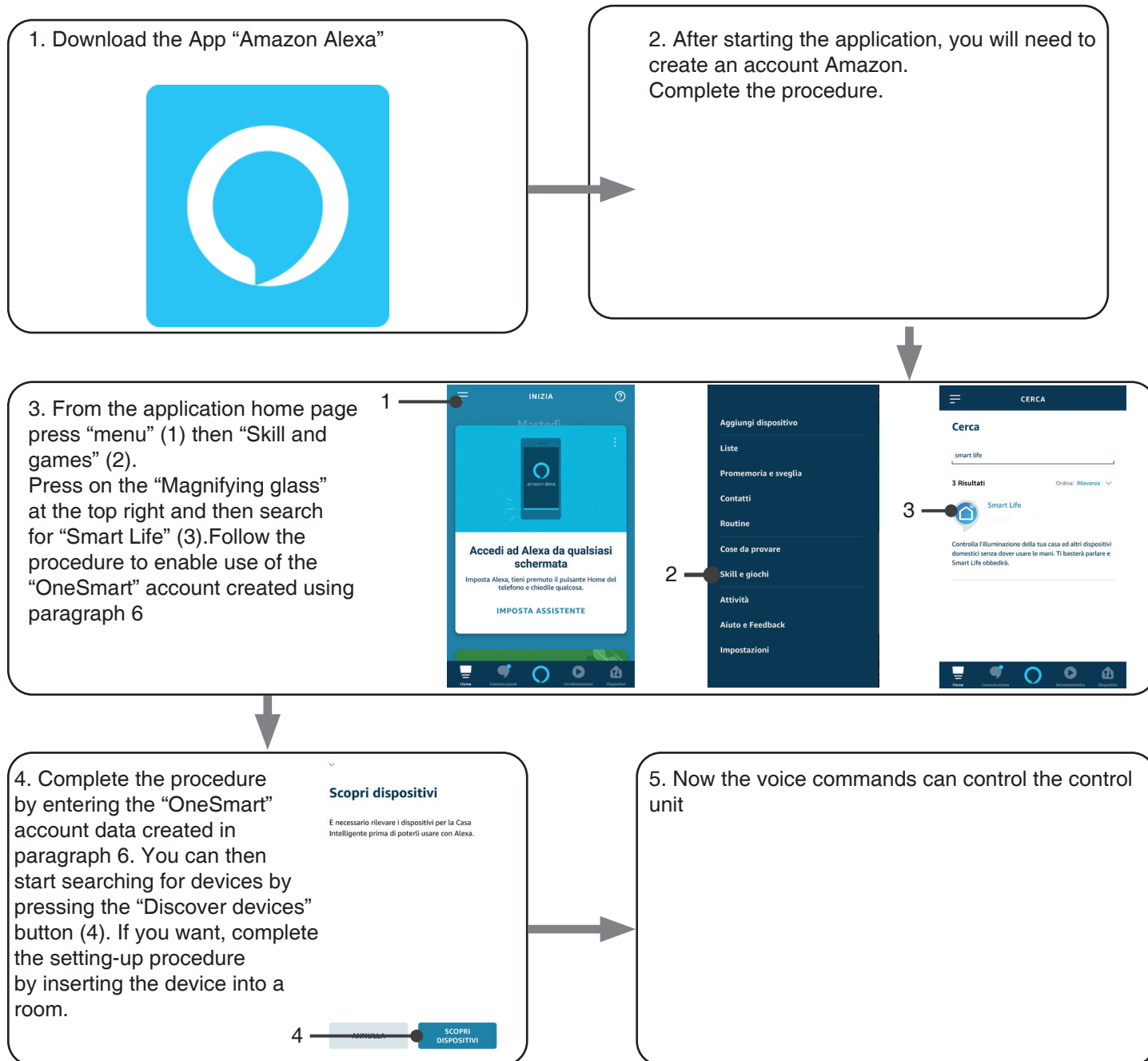

USE OF “AMAZON ALEXA”

SENDING VOICE COMMANDS

Using your Android mobile phone (or tablet), voice commands can already be sent via the Amazon Alexa application. Using an Apple device, you can use the microphone inside the Amazon Alexa application. If you want to add a voice-control device like “Echo Dot” or “Echo Plus”, follow the procedures to match it to the house you created, and then they will be associated with the lights.

COMMAND LIST

Here below there are some examples of dedicated voice commands for lights:

Alexa, Turn on / Turn Off *name of the device* or *name of the room*

Alexa, Turn on / Turn Off the lights

7 - ADVANCED PROGRAMS

7.1 - SETTING TYPE OF INPUTS VIA WIRE "P1"

STEP 1

Press and hold buttons RADIO and WIFI simultaneously (approximately 2 seconds):
LED is cyclically green and blue.
Release the key when the led is green

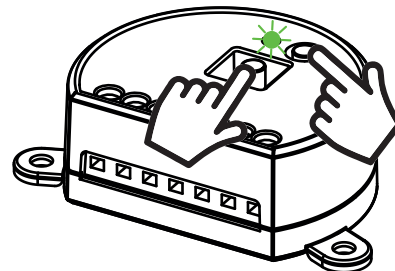

ACTION: Long press of buttons RADIO e Wi Fi **LED:** Turns on green/blue

INPUT 1 SETTING

STEP 2a

Press the button RADIO on the receiver for a short time and count the number of Flashes emitted by the LED:

NUMBER OF FLASHES	FUNCTION
3	Button (default)
6	Switches

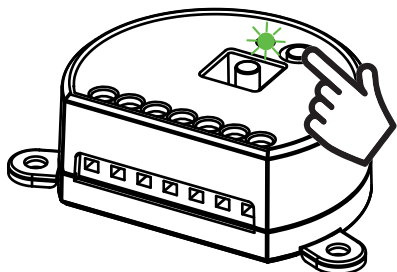

ACTION: Short pressure RADIO button
LED: Flash

INPUT 2 SETTING

STEP 2b

Press the button WiFi on the receiver for a short time and count the number of Flashes emitted by the LED:

NUMBER OF FLASHES	FUNCTION
3	Button (default)
6	Switches

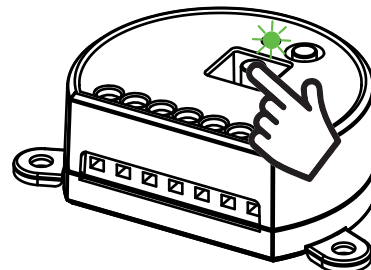

ACTION: Short pressure WIFI button
LED: Flash

STEP 3

To change the setting, repeat the procedure from point 1; the control unit will alternate between 3 and 6 Flashes

7.2 - FUNCTION CUSTOMIZATION OF THE “WIRELESS BUS” GENERIC TRANSMITTER BUTTONS

The following procedure allows you to set a custom function to the “wireless bus” family transmitter button.

GENERIC RADIOTRANSMITTERS (WIRELESS BUS), CODES:
 HB80-6G, MCU-TX4, TOUCH-1G, TOUCH-2G, TOUCH-4G, TOUCH-LOCK4, TOUCH-TX2, ROUND-1G

PROCEDURE

ASSOCIATION ON THE OUTPUT 1

STEP 1a

Press the button RADIO.
 The led turns on red.

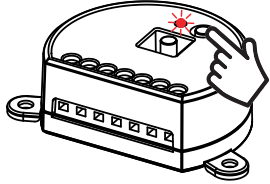

ACTION: Short press of button RADIO
LED: Turns on red

ASSOCIATION ON THE OUTPUT 2

STEP 1b

Press the button WIFI.
 The led turns on red.

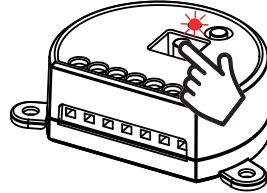

ACTION: Short press of button WIFI
LED: Turns on red

STEP 2a

Press the button WiFi on the receiver for a short time and count the number of Flashes emitted by the LED:

NUMBER OF FLASHES	FUNCTION
1	On
2	Off

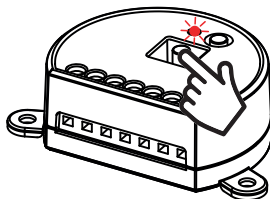

ACTION: Short press of button WIFI
LED: Count the number of Flashes

STEP 2b

Press the button RADIO on the receiver for a short time and count the number of Flashes emitted by the LED:

NUMBER OF FLASHES	FUNCTION
1	On
2	Off

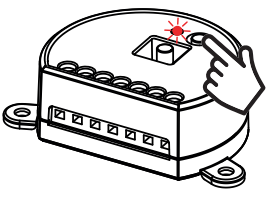

ACTION: Short press of button RADIO
LED: Count the number of Flashes

STEP 3a

Press the button Wi Fi for a short time during the Flash that corresponds to the function desired to end the count.
 The led stop Flashes

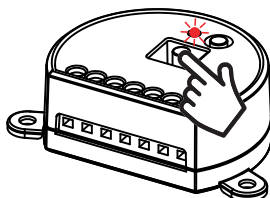

ACTION: Short press of button WIFI
LED: Stop Flashes

STEP 3b

Press the button RADIO for a short time during the Flash that corresponds to the function desired to end the count.
 The led stop Flashes

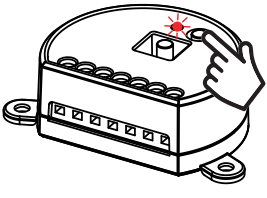

ACTION: Short press of button RADIO
LED: Stop Flashes

STEP 4

Make a transmission with the transmitter to be saved (see transmitter manual, paragraph entitled “transmitter programming”).
 The LED on the receiver Flashes 3.times and turns off.

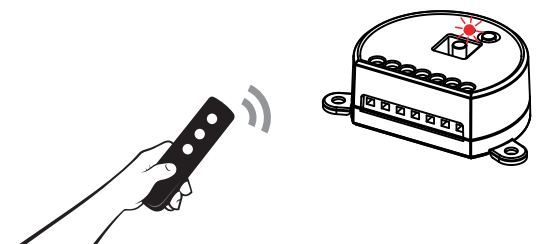

ACTION: Make a transmission with the transmitter **LED:** Flashes 3 times

7.3 - SETTING TIMING

Default: 18 hours

This procedure is used to set the time for which the Leds stays on before an automatic switch off.

All commands reset the time count to zero, excluding the following commands that will immediately turn off the light: short press by wired push button, command OFF by radio transmitter command by App or voice.

PROCEDURE

STEP 1

Press and hold buttons RADIO and WIFI simultaneously (approximately 2 seconds): the LED is cyclically green and blu.
Release the key when the led is blue

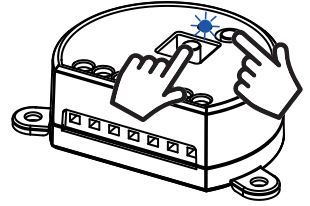

ACTION: Long press of buttons RADIO e Wi Fi **LED:** Turns on green/blue

TIMER OUTPUT 1

TIMER OUTPUT 2

STEP 2a

Press the button RADIO on the receiver for a short time and count the number of Flashes emitted by the LED:

NUMBER OF FLASHES	FUNCTION
1	No timing
2	1 minute
3	5 minutes
4	15 minutes
5	30 minutes
6	1 hour
7	2 hours
8	3 hours
9	8 hours
10	12 hours
11	18 hours

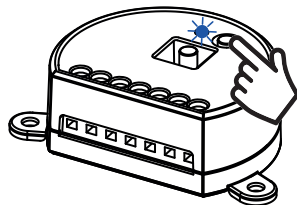

ACTION: Short pressure RADIO button
LED: Flash

STEP 2b

Press the button WIFI on the receiver for a short time and count the number of Flashes emitted by the LED:

NUMBER OF FLASHES	FUNCTION
1	No timing
2	1 minute
3	5 minutes
4	15 minutes
5	30 minutes
6	1 hour
7	2 hours
8	3 hours
9	8 hours
10	12 hours
11	18 hours

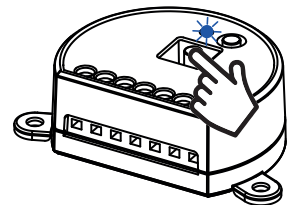

ACTION: Short pressure WIFI button
LED: Flash

STEP 3a

Press the button RADIO for a short time during the Flash that corresponds to the function desired to end the count.

The LED gives a number of yellow Flashes equal to the setting and turns off.

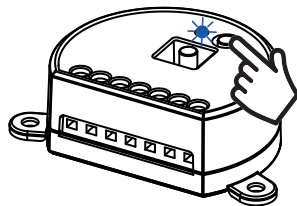

ACTION: Short pressure RADIO button
LED: Turns off

STEP 3b

Press the button WIFI for a short time during the Flash that corresponds to the function desired to end the count.

The LED gives a number of yellow Flashes equal to the setting and turns off.

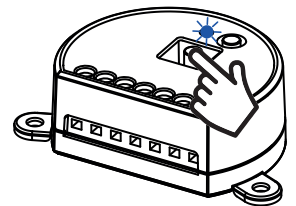

ACTION: Short pressure WIFI button
LED: Turns off

NOTE: to change the setting, repeat the procedure from point 1; the control unit will alternate between 3 and 6 Flashes

7.4 - RESET OF THE CONTROL UNIT

This procedure let you take the control unit back to factory settings.

ATTENTION: the only parameter that will not be removed will be the association with the ONESMART application.
To edit or delete also this parameter, reed the procedure.

PROCEDURE

STEP 1

Hold the receiver button RADIO down (about 4 seconds.)
until the LED begins to Flash.

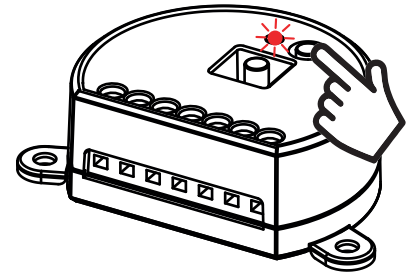

ACTION: Hold button RADIO down **LED:** Flashes red



STEP 2

Within 10 seconds, make a short press of WiFi button.
The LED 1 Flashes quickly and turns off.

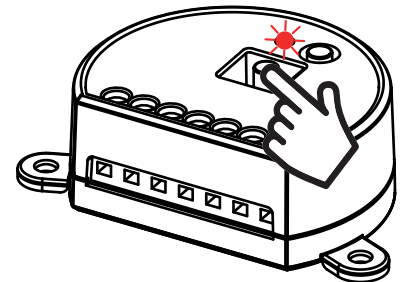

AZIONE: Short press of Wi Fi button **LED:** the led Flash quickly and turns off

CE



V2.0

LEF
Lighting

LEF LIGHTING S.R.L.
Viale L. Ariosto 478, 50019
Sesto Fiorentino
Tel. 055.4217727
Firenze - ITALY
www.leflighting.it