

USER GUIDE

DLE1012SN, DLE1012SB, DLE1012STR

Floor independent dimmers for incandescent lamps and LED lamps



www.lef Lighting.it

General Characteristics

Plastic case
Slider potenziometer control with push-button switch

ATTENTION:

The installation of the product must be followed by qualified personnel.
If the product is used for purposes other than the original ones or if it is connected incorrectly, LEF Lighting S.R.L. will not accept any responsibility for damages caused.

Reference Standards

EN 61058-1
EN 61058-2-1

Technical Features

Input voltage range 220-240Vac

Input frequency 50+60Hz

Dimming control through:

- switch
- slide potentiometer

Suitable for:

- incandescent lamps
- halogen lamps
- dimmable compact fluorescent lamps (CFL)
- dimmable LED lamps

Min -Max adjustment through slide potentiometer

Memorization of the last setting made (even in case of switching-off from controlled electrical socket)

Built-in replaceable fuse T 2,5AH 250V

SWITCH	DIM POT
--------	---------

CODICE CODE	Colore Color	RESISTIVO RESISTIVE Lampade ad incandescenza o alogene Incandescent or halogen lamps 230Vac	INDUTTIVO INDUCTIVE Trasformatore lamellare Laminated transformer 230/12Vac	INDUTTIVO INDUCTIVE Trasformatore toroidale Toroidal transformer 230/12Vac	Alimentatore elettronico con lampade ad incandescenza o alogene Electronic driver with incandescent or halogen lamps 230/12Vac	Alimentatore elettronico con lampade LED dimmerabili Electronic driver with dimmable LED lamps 230/12Vac	Alimentatore elettronico dimmerabile con uscita in CC/CV per LED Dimmable electronic driver with CC/CV output for LED	Lampade fluorescenti compatte dimmerabili Dimmable compact fluorescent lamps 230Vac	Lampade LED dimmerabili Dimmable LED lamps 230Vac	Moduli LED dimmerabili Dimmable LED modules Seoul ACRICH 230Vac	Peso Weight (g)
DLE1012SN	Nero Black	4-250W	-	-	-	-	-	11-25W	4-25W	-	150
DLE1012SB	Bianco White										
DLE1012STR	Trasparente Transparent										

ASSEMBLY INSTRUCTIONS (FIG. 1)

Unscrew the locking screws **A**.

Remove cover **B**.

Unscrew screw **C** of the cable clamp plate **D**.

Strip and strip the cable to be connected according to the measurements indicated.

Connect the power supply to terminals **L**, **N** and \oplus of the circuit board.

Connect the lamp cable to the marked terminals \otimes and \oplus of the circuit board.

Assemble the cable clamp plate **D** using screw **C**

(N.B.: orient the cable clamp plate **D** as indicated in relation to the type of cable, flat or round, to be connected).

Assemble cover **B**, screwing in screws **A**.

REMOVE VOLTAGE BEFORE REPLACING FUSE T2.5A H 250V. THIS OPERATION MUST ONLY BE CARRIED OUT BY SPECIALISED TECHNICAL PERSONNEL.

MINIMUM SETTING

Move the slider from minimum to maximum 5 times.

Each complete movement of the slider from minimum to maximum and on the contrary must be completed in approx. 0.5 seconds.

Once in this function:

- The lamp is switched on at maximum brightness for approx. 2 seconds.
- Every two seconds the minimum brightness is changed sequentially to 6 predefined values.
- To confirm the minimum brightness level of the lamp, move the slider to the chosen value.

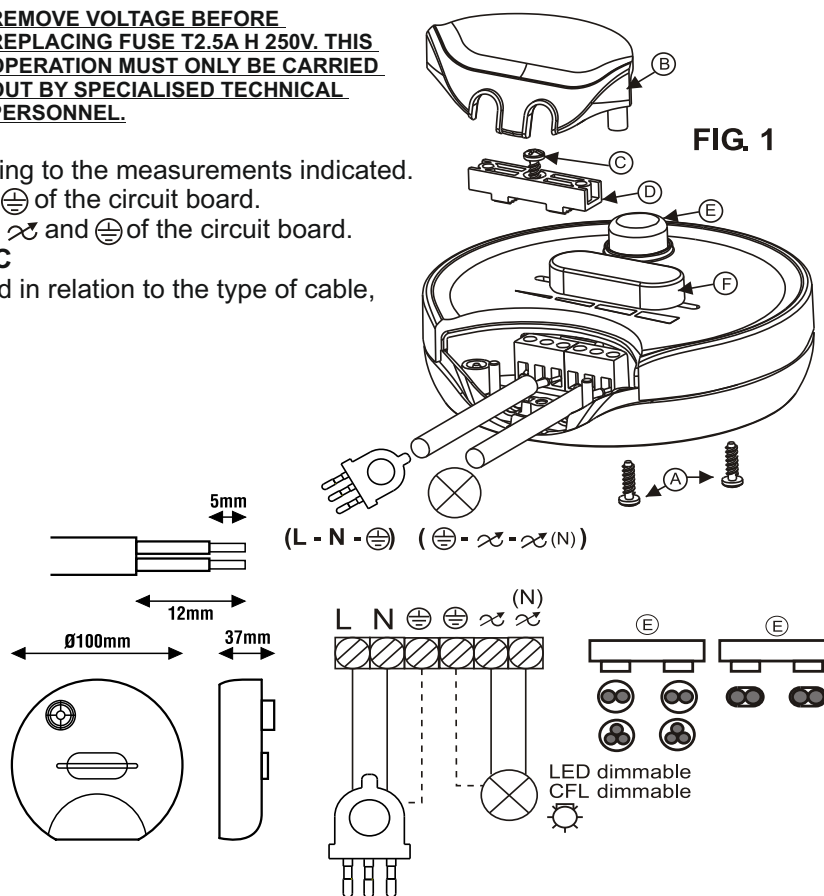

MADE IN ITALY



PRODUCT TO BE DISPOSED DIFFERENTLY FROM URBAN WASTE
AEE identification nr.IT18040000010321

LEF LIGHTING S.R.L. www.lef Lighting.it

Viale L.Ariosto 478/480 - 50019 Sesto Fiorentino (FI) - ITALY | Tel +39 055 421 77 27 - Fax +39 055 425 44 92