

USER GUIDE

LE3048A

Constant voltage LED driver (CV)



www.lef-lighting.it

General Characteristics

Plastic case
Driver for independent mounting
Electric class protection II
Protection degree IP20

Reference Standards

EN 55015
EN 61000-3-2
EN 61347-1
EN 61347-2-13
EN 61547
EN 62384

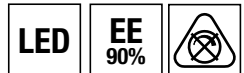
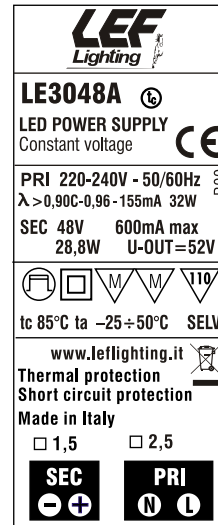

CODICE CODE	Tensione di ingresso Input voltage (Vac)	Frequenza di rete Input frequency (Hz)	Potenza di uscita Output power (W)	Comando Command	Tensione di uscita Output voltage (Vdc)	Corrente di uscita Output current (mA)	PFC (λ)	CC CV	Peso Weight (g)
LE3048A	220-240	50÷60	28,8	ON-OFF	48	600	0,95	CV	100

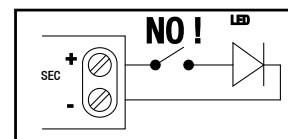
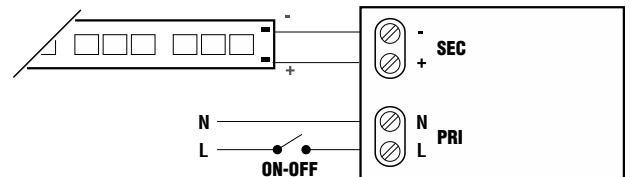
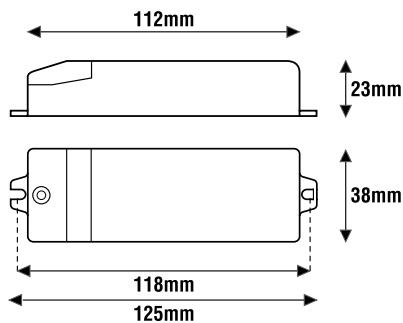

Technical Features

Input voltage range 220-240Vac
Input frequency 50÷60Hz
Constant voltage output 48Vdc
Energy Efficiency (EE) 90%
Open circuit protection (OCP)
Overload protection (OLP)
Protection against overtemperature (OTP)
Short circuit protection (SCP)
Power factor correction (PFC) $\lambda \geq 0,95$
Operating ambient temperature T_a -20°C ÷ +50°C
Max case temperature on T_c 85°C

N.B.

Power supply not suitable for
no-load operation.

ATTENTION:

The installation of the product must be followed by qualified personnel.
If the product is used for purposes other than the original ones or if it is connected incorrectly, LEF Lighting S.R.L. will not accept any responsibility for damages caused.

MADE IN ITALY



PRODUCT TO BE DISPOSED DIFFERENTLY
FROM URBAN WASTE
AEE identification nr.IT18040000010321



LEF LIGHTING S.R.L. | www.lef-lighting.it

Viale L.Ariosto 478 - 50019 Sesto Fiorentino (FI) - ITALY | Tel +39 055 421 77 27 - Fax +39 055 425 44 92